

**AGMA Motion and Power Technology Expo 2021**  
 September 14 - 16, 2021  
 Americas Center Halls 1 - 5  
 St. Louis, Missouri

Preco, Inc. 1935 TEC-Master 1933	Zopus 2035 Shaworth Co. LLC 2132	Thors, LLC 2133	20' O'Brien 2334	20' O'Brien 2332	20' Louis Belet 2701 20' Gibbs 2800	30' Reishauer Corporation 2809	20' J.G. Weisser Sales GmbH & Co. 2715	20' Ovako North America 2721	20' IPH, Inc. 2727 20' Doppler Gear 2828	20' MB Metal 2731	20' Croix Gear 2735	Sales Office 2741
20' Roly 2028 20' Centu 2026	20' ASCO 2029 20' S. B. B. 2027	20' Magna 2129 20' Forgo 2127	20' Nagel 2229 20' Clear 2227	20' Ameri 2227 20' Clear 2226	20' Napol 2329 20' Ruse 2327	20' Cincinnati Clearing Systems 2801	20' Dentyne 2815 20' Walke 2814	20' 2821 20' 2822 20' Sree 2822	20' 2827 20' 2829 20' 2831	20' Gear Motions / Kinatex 2835		
1923 2022	2023 2122	2123 2222	20' Hoffmann Filter Corporation 2221	20' Bevel Gear 2422	20' Great Lakes Gear Technology, Inc. 2901	20' Viking Forge 2909 20' Ash Gear 2911 20' Precision 3008	20' New England Gear 2915	20' S.L. Munson & Co. 2921	30' AGMA 2927	30' Pirelli Enterprises Inc 2935	20' 2943 20' 3042	
1919 2018	2017 2116	2115 2214	20' Power Trans 2217 20' Power Trans 2218	20' Delia 2414	20' DVS Technology America 3007	20' Forest City Gear Company 3007	20' Hayes 3015	20' Rotec Tools 3021	30' AGMA Foundation 3127	20' SMT Cumi America 3035 20' DTR 3037	20' Ily Mills 3138	20' 3043 20' 3142
1915 2014	20' Meritor 1909	20' 2009 20' 2108	20' Kupra 2107 20' 2208	20' Great Lakes Gear Technology, Inc. 2209	20' Reser 3206 20' Gear 3208	20' Great Talwa 3107 20' Precision 3111	20' Gleason Corporation 3115	20' Global Gear 3121 20' DWJ Techn 3125 20' MESY S AG 3121 20' DixTech CNC 3220	20' Southern 3135 20' DixTech CNC 3220	20' 3139 20' 3139	20' Engineers 3243	

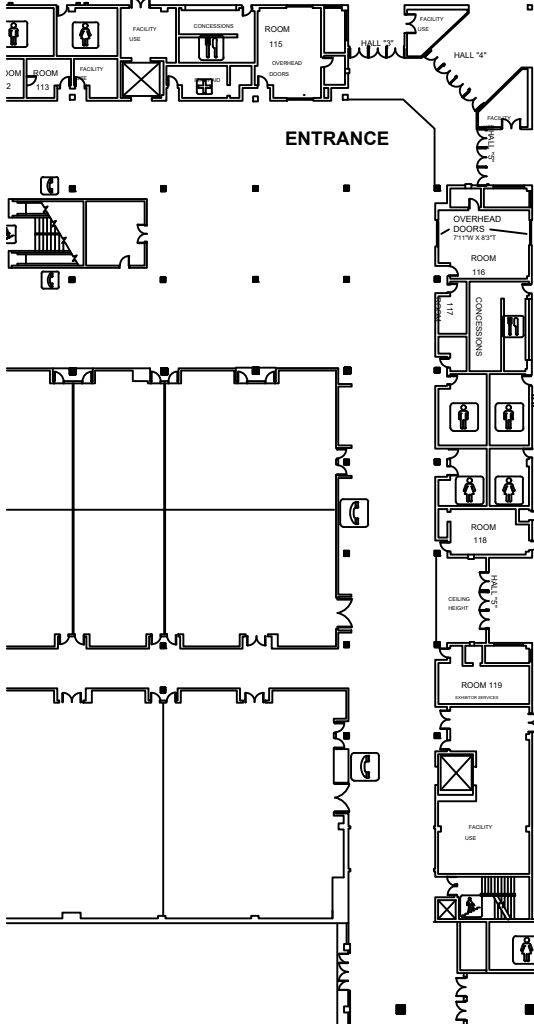

50' EMAG LLC 3203	30' Mitsubishi Heavy Industries America, Inc. Machine Tool Division 3303	20' Riley Gear Corporation 3415	20' Riemann 3502 20' 3506	20' Machine Tool Builders Inc. 3608	20' Riemann 3503 20' 3505	20' Riemann 3503 20' 3505	20' Riemann 3503 20' 3505	20' Riemann 3503 20' 3505	20' Riemann 3503 20' 3505	20' Riemann 3503 20' 3505	20' Riemann 3503 20' 3505	20' Riemann 3503 20' 3505
20' 3203	20' 3303	20' 3415	20' 3502 20' 3506	20' 3608	20' 3503 20' 3505	20' 3503 20' 3505	20' 3503 20' 3505	20' 3503 20' 3505	20' 3503 20' 3505	20' 3503 20' 3505	20' 3503 20' 3505	20' 3503 20' 3505
20' 3203	20' 3303	20' 3415	20' 3502 20' 3506	20' 3608	20' 3503 20' 3505	20' 3503 20' 3505	20' 3503 20' 3505	20' 3503 20' 3505	20' 3503 20' 3505	20' 3503 20' 3505	20' 3503 20' 3505	20' 3503 20' 3505
20' 3203	20' 3303	20' 3415	20' 3502 20' 3506	20' 3608	20' 3503 20' 3505	20' 3503 20' 3505	20' 3503 20' 3505	20' 3503 20' 3505	20' 3503 20' 3505	20' 3503 20' 3505	20' 3503 20' 3505	20' 3503 20' 3505

Thursday Sept. 9th  
 8:00 am  
 12:30 pm

Friday Sept. 10th  
 8:00 am  
 12:30 pm

